

THE ALL-NEW ISUZU ELF

NEXT-LEVEL RELIABILITY



6 Wheeler

NPR PRO
GVW 5,000kg

NPR 150
GVW 5,000kg

NPR PRO
GVW 8,500kg

ISUZU
ELF

Durability

Designed To Deliver

Durability and reliability are taken to a higher level by employing cutting-edge digital design analysis.



NQR



NPR



WIDEST
Brake Lining

HIGHEST
Axle Capacity

Bigger Axle Capacity (Up to 9.7 tons*)

Increased durability when handling maximum load.

*Based on axle capacity design.

Wider Brake Lining

More durable when carrying maximum load and contributes to longer-lasting brakes.

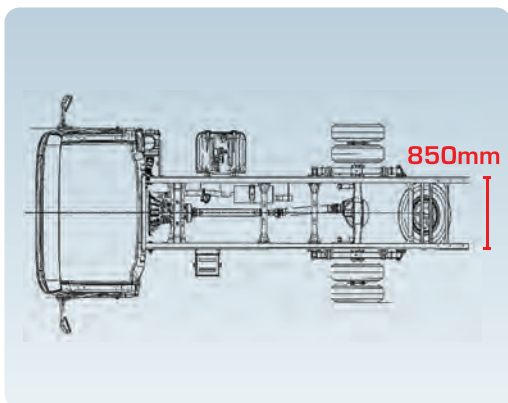

Wider Chassis Frame (850mm)

Unlike our competitors in the market, the Isuzu ELF provides better bending strength and better stability when carrying maximum load.

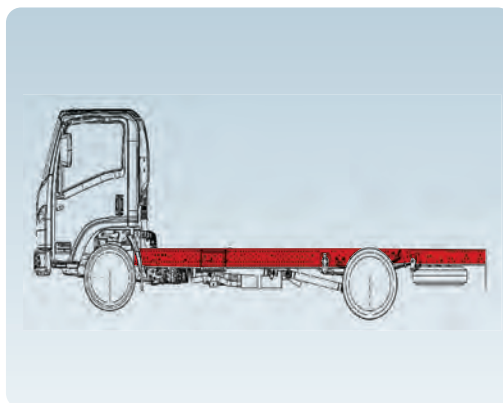

One Piece Straight Chassis

Even load distribution ensures better stability for heavy usage. Chassis without rivets guarantee effortless body mounting.

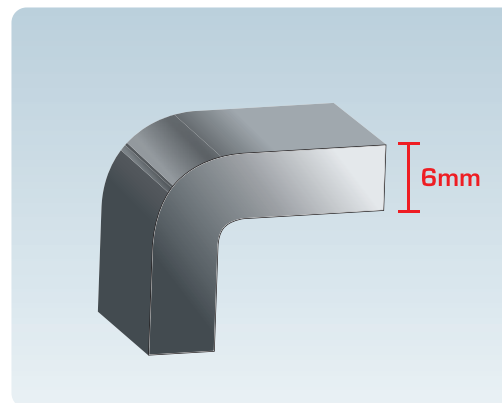

6mm Thick Chassis Frame

A stronger, lighter and thicker chassis frame provides greater strength for any job.



Longer Leaf Spring

The extended spring is sturdier, capable of handling higher loads with less deflection.

Next-Level Reliability

Introducing the next generation of excellence. The new Isuzu ELF gives you higher performance on every level – styling, engineering, safety, economy and environmental-friendliness – all based on new global standards. By offering a wide range of variants, the new Isuzu ELF meets the needs of businesses with a model perfect for every application, while working in harmony with society and the environment.



Performance

Power and Efficiency

High output and superb fuel efficiency – Isuzu diesel technology pioneers new territory.

The Advanced Next-Generation Engine

The all-new 4HK1-TC with High-Pressure Common Rail Fuel Injection System and Isuzu 6-speed transmission (MYY6S) offers best-in-class* power as well as superb fuel economy, making Isuzu ELF ideal for businesses seeking cost-effective operation.

★ Best in Class*



4HK1-TC HEAVY DUTY COMMONRAIL

Displacement : 5,193cc
Max. Output : 150PS @ 2,600rpm
Max. Torque : 404Nm @ 1,600-2,600rpm

150PS
Max Power

404Nm
Flat Torque

Superb Flat Torque

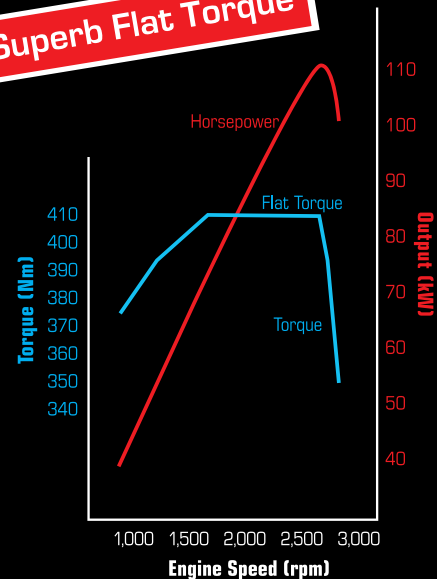

Proven Performer

The powerful, easy-to-handle 4HG1-T engine is now available on more models. With outstanding output and torque as well as proven durability and reliability, it's ideal for a large variety of applications.



4HG1-T

Displacement : 4,570cc
Max. Output : 125PS @ 2,850rpm
Max. Torque : 325Nm @ 1,800rpm

*Highest output and torque in 5 ton GVW category.

Exterior

Solid and Sculptured

In pursuit of a design with lasting appeal, Isuzu made effective use of lines between cabin parts and included no superfluous decoration. Its exterior cabin's high rigidity, aerodynamically efficient design and user-friendliness ensure that the functionality of a light duty truck is not compromised.



Bigger Halogen Headlamps

Clear resin lenses and headlamp reflectors provide outstanding illumination over a broad area to improve night-time visibility and safety.



Excellent Ingress/Egress

90-degree wide door opening and longer handle grip provide effortless cabin access along with a larger step area and wider cabin floor.



Vertical Outside Handles

Vertical handles make it easier to access tall vehicles. In addition, grips are designed to accommodate thick gloves.

Interior

Ultimate Workspace

Specifically designed with excellent accessibility, the cabin is a workspace designed for maximum utility, safety and comfort. The spacious cabin makes driving more comfortable with ergonomically placed interior panels to provide ample room. The redesigned seat reduces driver fatigue and allows easier ingress and egress.



Ergonomic Instrument Panel Design

The switches are ergonomically designed and positioned for improved visibility within the driver's field of view.



Central Locking and Power Windows

Easier, more convenient operation for drivers.



Best-In-Class Cabin Space*

With an expanded head clearance, vertical front pillar and larger space behind the seats, the cabin can easily fit three adults comfortably.

*Biggest Cabin Space in 5 and 8.5 ton GVW category.

Safety

Safety First

A highly rigid cab minimises collision impact and protects the driver by creating a survival zone. The Isuzu ELF also promises improved stability in every road condition even with a full load.

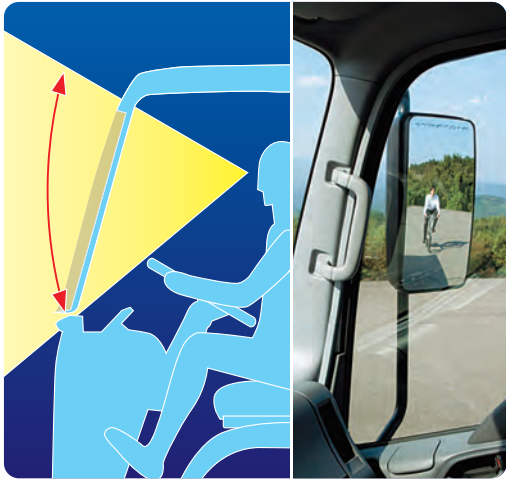

Wider Windscreen and Bigger Side Mirrors

Offer extra visibility of surroundings, reducing blind spots (in compliance with UNECE Regulations).

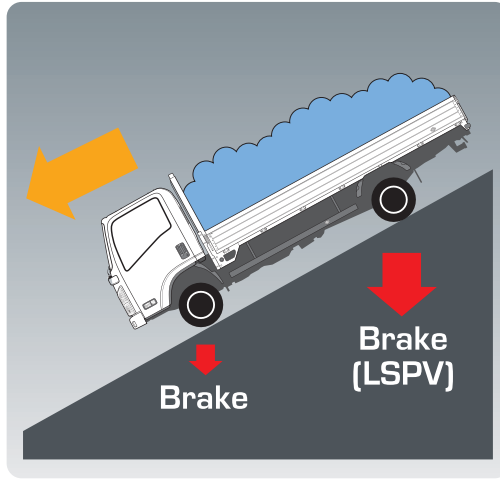

Load Sensing Proportioning Valve (LSPV)

Senses the load on vehicle and evenly distributes brake force to avoid skidding during sudden braking.



6-Stud Radial Tyres*

Provide better handling and stability, and more resistant to punctures. The 6 studs contribute to durability when supporting heavier loads.

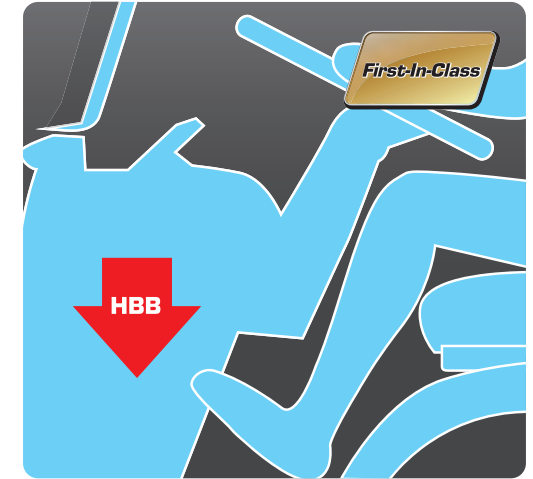

Hydraulic Brake Booster (HBB)**

Higher brake assist force with more durable brake lining.

*Available for NPR71UKH, NPR75UKH and NQR only.

**Available for NQR only.

Body Application

With the widest treads in its class, the new Isuzu ELF 6 wheeler allows installation of cargo bodies up to 2,600mm (8ft 6in) high and 2,429mm (7ft 11.5in) wide.

The chassis wheelbase modification to 4,600mm (15ft) allows for cargo space up to 6,280mm (20ft 6in) long, offering greater versatility for any business.

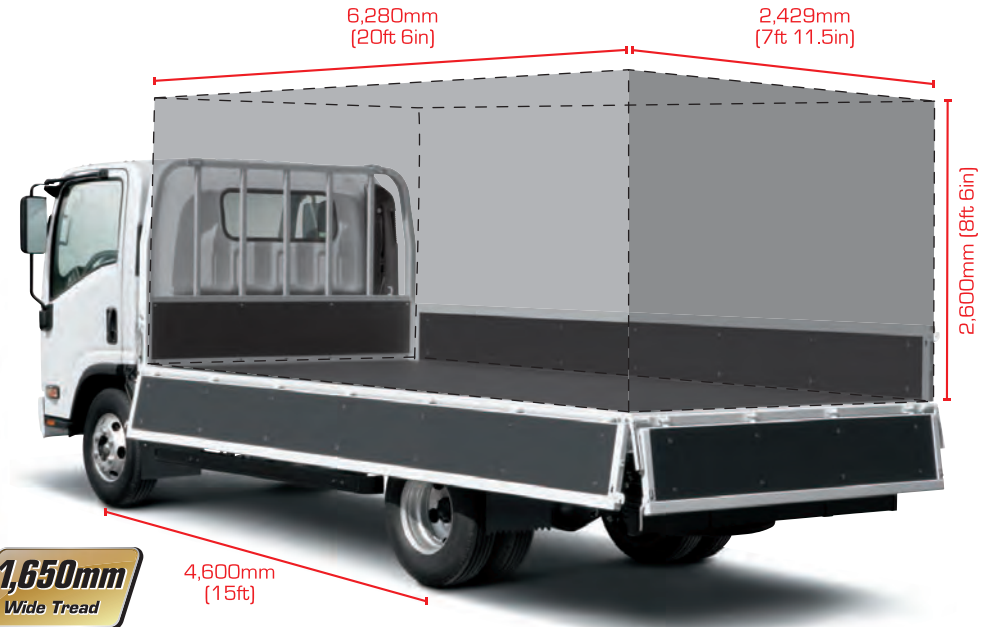

• JPJ Regulation Compliance and Specifications may vary.

SPECIFICATION SHEET

MODEL CODE

	NPR PRO		NPR 150		NGR PRO	
	NPR71UHH	NPR71UKH	NPR75UHH	NPR75UKH	NGR75UKN	NGR75ULN

Drive Train	4 x 2					
Wheelbase	mm	3,365	3,815	3,365	3,815	4,175
ENGINE						
Model	4HG1-T		4HK1-TC			
Type	4-Cylinder In-line, 4-Cycle, Water-Cooled					
	OHC, Turbo		DOHC, Turbo with Intercooler			
Displacement	cc	4,570		5,193		
Maximum Output	kW (PS) @ rpm	92 (125) @ 2,850		110 (150) @ 2,600		
Maximum Torque	Nm (kgm) @ rpm	325 (33) @ 1,800		404 (41) @ 1,600-2,600		
Emission Level	Euro 2					
Fuel System	Direct Injection		Common Rail Direct Injection			
WEIGHT & CAPACITIES						
Gross Vehicle Weight	kg	5,000			8,500	
Curb Weight	kg	2,245	2,405	2,455	2,490	2,715
Front	kg	1,525	1,550	1,610	1,630	1,710
Rear	kg	720	855	845	860	1,005
Fuel Tank Capacity	l	100				
AXLE						
Front	Type	Reverse Elliot, I-Beam				
Front Axle Capacity (Design)	kg	3,100				
Rear	Type	Banjo, Full Floating				
Rear Axle Capacity (Design)	kg	5,000	6,600			
SUSPENSION SYSTEM						
Suspension	Front	Semi Elliptical Alloy Steel Leaf Spring with Double Acting Telescopic Shock Absorber				
	Rear					
TYRES & WHEELS						
Tyres		7.00R-16-10PR	7.50R-16-10PR	7.00R-16-10PR	7.50R-16-10PR	7.50R-16-14PR
Wheels		5.50F-115	6.00GS-127	5.50F-115	6.00GS-127	
BRAKES						
Service		Drum Brakes with Dual Circuit Hydraulic Control, Vacuum Assistance and Load Sensing Proportioning Valve (LSPV)			Drum Brakes with Dual Circuit Hydraulic Brake Booster (HBB) and Load Sensing Proportioning Valve (LSPV)	
STEERING						
Steering System		Power Assist, Recirculating Ball Type				
Min. Turning Radius	m	6.30	7.10	6.30	7.10	7.80
ELECTRICAL						
Battery		24V				
Alternator		24V-50A				

Isuzu Malaysia Sdn. Bhd. is engaged in an ongoing research and development programme, and reserves the right to change specifications, resulting in advancements or technical refinements, without prior notice. All product specifications are within normal manufacturing allowances and tolerances.



United Nations Economic Commission for Europe (UNECE) Regulations contain provisions for automotive related to safety and environmental aspects at global standard.

ISUZU

ISUZU MALAYSIA SDN BHD (66494641)
 501D, LEVEL 5, TOWER D, UPTOWN 5,
 NO 5, JALAN SS21/39, DAMANSARA UPTOWN,
 47400 PETALING JAYA, SELANGOR DARUL EHSAN.
 GENERAL LINE: 03-7723 9777 FAX: 03-7723 9779
 HOTLINE: 1-300-88-1133 www.isuzu.net.my

**SPARE PARTS
 WIDELY
 AVAILABLE**



Accessories
 Warranty Varies

TRANSMISSION		Gear Ratio							
		1st	2nd	3rd	4th	5th	6th	Reverse	Final
NPR71UHH	5-Speed Manual (MYY-5T)	5.315	3.053	1.655	1.000	0.721	-	5.068	6.142
NPR71UKH									
NPR75UHH									
NPR75UKH	6-Speed Manual (MYY-6S)	5.979	3.434	1.862	1.297	1.000	0.759	5.701	5.125
NGR75UKN									
NGR75ULN									

DIMENSIONS		NPR71 UHH	NPR71 UKH	NPR75 UHH	NPR75 UKH	NGR75 UKN	NGR75 ULN
Overall Length	OAL	mm	5,985	6,635	5,985	6,635	7,355
Overall Width	OAW	mm	2,085	2,125	2,085	2,125	2,125
Overall Height	OAH	mm	2,255	2,275	2,255	2,275	
Wheelbase	WB	mm	3,365	3,815	3,365	3,815	4,175
Front Overhang	FOH	mm	1,110				
Rear Overhang	ROH	mm	1,510	1,710	1,510	1,710	2,070
Front Tread	AW	mm	1,680				
Rear Tread	CW	mm	1,650				
Cab to Axle	CA	mm	2,795	3,245	2,795	3,245	3,605

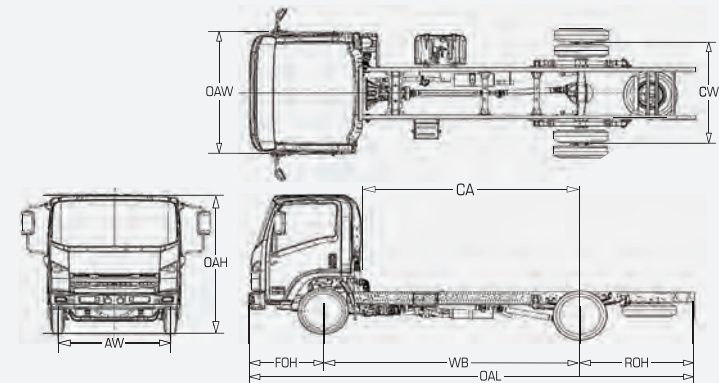

WHEELBASE MODIFICATION

WHEELBASE		NPR71	NPR75	NGR75
Standard 1	mm	3,365		3,815
Standard 2	mm		3,815	4,175
Option 1	mm		4,175	4,600
Option 2	mm		4,600	-

Dealer's information